

# City of South Daytona

## Parks and Recreation

504 Big Tree Road • South Daytona, FL 32119 • 386/322-3070



### MEMORANDUM

**To:** James L. Gillis, Jr., City Manager

**From:** Amy Zengotita, CPRP, Parks and Recreation Director

**Re:** Consideration of awarding the Magnolia Park Playground project (Bid No. 23-B-008) to REP Services, Inc in the amount of \$226,154.05 as budgeted in the current fiscal year and funded by a 2022 Volusia County ECHO (Environmental, Cultural, Historical, or Outdoor Recreation) Grant.

**Date:** April 3, 2023

---

On August 2, 2022, the Volusia County Council approved the City's ECHO Grand Award for \$243,750 for Magnolia Park Improvements. The ECHO grant is designed for Environmental, Cultural, Historical, or Outdoor Recreation projects and provides a fifty percent (50%) match of funds.

The Parks and Recreation Director put an enormous amount of effort into the application knowing how important it was to revitalize this underutilized park. The proposed improvements include the complete replacement of all playground equipment. It also includes the replacement of the entire boardwalk along the pond to maximize accessibility which was completed in March. Enhanced landscaping is scheduled to be installed along with a fence replacement and parking lot improvements. The pond will also be stocked to encourage fishing from the newly installed dock.

To facilitate the timely replacement of this equipment, staff utilized a bid process seeking contractors to replace the Playground with a Fishing Theme.

Although only one bid was received, staff has reviewed and has confirmed that pricing is fair and reasonable. The City has worked with Bliss Products and Services Inc in the past as they were the contractor for Riverfront Veterans Memorial Park.

Staff recommends awarding the Magnolia Park Playground project (Bid No. 23-B-008) to REP Services, Inc in the amount of \$226,154.05 as budgeted in the current fiscal year and funded by a 2022 Volusia County ECHO Grant.

If the project is awarded, construction is set to begin in Summer 2023.



Site Amenities ■ Playground Equipment ■ Safety Surfacing ■ Shade  
Phone: 407.831.9658 Fax: 866.232.8532 E-mail: sales@rep-services.com

# REP SERVICES, INC.

Experts at Play & Outdoor Spaces

Please mail POs, contracts and checks to:  
Rep Services, Inc.  
165 W. Jessup Ave.  
Longwood, FL 32750-4146

<b>Proposed To:</b> City of South Daytona Parks & Recreation Dept. 504 Big Tree Rd South Daytona, FL 32119-2808	<b>Ship To:</b> TBD at a later date	<b>Bill To:</b> City of South Daytona Parks & Recreation Dept. 504 Big Tree Rd South Daytona, FL 32119-2808
<b>Attn:</b> Amy Zengotita	<b>Attn:</b>	<b>Attn:</b> Amy Zengotita

<b>Project No:</b> 19712	<b>Project Name:</b> South Daytona - Magnolia Park	<b>Project Contact:</b> Amy Zengotita
<b>Proposal No:</b> 19712.04	<b>Proposal Name:</b> South Daytona - Magnolia Park Rev	<b>Project Location:</b> 1987 Magnolia Ave South Daytona, FL 32119
<b>Proposal Date:</b> 4/4/2023	<b>Proposal Expires:</b> 5/3/2023	<b>Project County:</b> Volusia
<b>For Questions Contact:</b> Shela Brown	☎ 407-853-3558	✉ shela@rep-services.com
<b>Consultant:</b> Mary Langley	☎ 407-853-3563	✉ mary@rep-services.com
		<b>Opt/Rev:</b> A/1 4/4/23 - SA

<b>Vendor:</b> Landscape Structures	<b>Proj Drawings:</b> 19712-1-3	587986
-------------------------------------	---------------------------------	--------

Class	Part No	Qty	Description	Unit Price	Net Price	Ext Price
<b>Play Area Ages 5-12</b>						
Custom	CP026909	1 EA	Bass Fish Climber DB - Fish Tail Wobble Pod. Fish Climber With Cables, Handgrips, Belt Seat, Swiggles, Crawl Through, Ring Pull, Belt Hangout On Top.	55,920.00	55,920.00	55,920.00
	CP031547	1 EA	6.5'x14' Fishing Boat W/rpl Roof And Fishing Pole DB - Cedar And Mink Rpl. Front Section Has Ship Wheel, Ring-a-bell, Slider, Talk Tube. Back Section Has Talk Tube, Upper Window Panels With Lexan And Permalene Fram, 2 Doorways, 42"x42" Oc Rpl Roof W/ Smok	33,015.00	33,015.00	33,015.00
Signs	IP182503C-001	1 EA	Welcome Sign (Isi Provided) - Ages 5-12 Years Direct Bury	0.00	0.00	0.00

				Product Subtotal:	\$88,935.00
				Signed & Sealed Engineering:	\$3,140.00
Freight: Prepaid Ship Method: Best Way FOB: Destination Weight: 4,624 lbs Freight Charge:					\$25,515.00
				<b>Landscape Structures Total:</b>	\$117,590.00

<b>Vendor:</b> Tot TurfRSI	<b>Proj Drawings:</b> 19712-1-3	587987
----------------------------	---------------------------------	--------

Class	Part No	Qty	Description	Unit Price	Net Price	Ext Price
Surfacing	EPDM8C1	1,870 SF	EPDM Poured in Place Safety Surfacing. Single Color Blend 50% Black/50% Standard Color, 3.75" thick at 8' CFH Pad 1 960 SF 50% RF22 light blue/50% black mix aliphatic urethane and RH10 green/50% black mix "lily pads" Pad 2 910 SF 50% RF20 blue/50% black mix aliphatic urethane and RH10 green/50% black mix "lily pads"	25.84	25.84	48,320.80

Freight: Prepaid Ship Method: Best Way FOB: Destination Freight Charge:				Included
<b>Tot TurfRSI Total:</b>				\$48,320.80

<b>Vendor:</b> RSI Installer	587988
------------------------------	--------

Item	Qty	Description	Unit Price	Ext Price
INS-LSI	1 LT	Equipment Installation - Landscape Structures Design 19712-1-3	36,695.00	36,695.00
INS-CON CURB	69 LF	Installation of concrete curbing w/ rebar 6"x12"	63.25	4,364.25
INS-SURFACING SUBBASE	1,870 SF	Install subbase for surfacing - #57 crushed recycled concrete	4.50	8,415.00
OTHER	1 EA	Additional Scope Provided By Other/Customer Removal of existing equipment with footings, surfacing, curb, trees with root systems and anything other than soil within the playground footprint Removal of EWF prior to play equipment to avoid EWF being buried in old footing holes and later creating voids under the surfacing.	0.00	0.00

<b>RSI Installer Total:</b>			\$49,474.25
			587990

--	--	--	--	--

General Terms of Sale and Proposal Summary

Net 30	Product:	\$140,395.80
	Installation:	\$60,243.25
	Freight:	\$25,515.00
	Proposal Total:	\$226,154.05

Notes

**Basis of Proposal:**  
Our offer is based upon Google Earth Image and our drawing 19712-1-3  
**Demo and removal of existing equipment, surfacing and trees not included**

**Performance and payment bond at 5% of the proposal total has been included**

Also, please be aware that we generate separate invoices for product at the time of delivery, then we invoice for installation upon completion. This is the customary approach in construction and eliminates sales tax on installation services. If your project should include products from multiple manufacturers, be advised that the products will be invoiced separately.

**Estimated project completion schedule**  
(This schedule starts when all needed information to direct engineering has been gathered.)  
5 Weeks: Engineering  
4 Weeks: Permitting/Submittal Approval  
22 Weeks Longest manufacturing lead time. (Typical for scheduling.)  
1 Week Shipping  
7 Weeks Installation  
39 Weeks TOTAL WEEKS  
Note that RSI is committed to do all it can to meet the needs of your project.

**Landscape Structures:**  
Color selection to be made at time of color submittal approval  
The Owner/Operator shall install protective surfacing in accordance with specifications F1292 and F1951, as applicable (ref. ASTM F3101-15 10.2).  
Protective surfacing material must have a critical height value to meet the maximum fall height for the equipment and be accessible (ref. ASTM F3101).

**ForeverLawn Playground Grass:**

- Rough Grade: to be established by others.
- Product: Foreverlawn Grass and all associated and required items (such as seaming tape, glue, etc).
- Installation: Performed by FOREVERLAWN, Inc.
  - Composite nailer boards around the perimeter.
  - #57 stone, spread and compacted.
  - SafetyFoam Pro padding will then be laid over the stone. The grass will then be laid over the pad, seamed and secured.
  - NOTE: Installation scopes do not include fall height testing.
  - Dumpster at the site for trash and waste material

**Installation:**  
Unless otherwise noted, the following items are to be *PROVIDED BY CUSTOMER* prior to installation:

- Signed & sealed site plan or survey.
- Access for machines and labor crew to equipment installation location.
- Staging area.
- Geotechnical Report.
- Tree survey and barriers.
- Private underground utilities located and marked.

Our scope does not include:

- **Demo and removal of existing equipment, surfacing and trees**
- Sod & Landscape Restoration.
- Dumpster at the site for trash and waste material.
- Soils testing.
- Site security.
- Water.
- Dewatering and drainage considerations.
- Concrete testing.

Additional Scope Provided By Other/Customer

- Removal of existing equipment with footings, surfacing, curb, trees with root systems and anything other than soil within the playground footprint
- Removal of EWF prior to play equipment to avoid EWF being buried in old footing holes and later creating voids under the surfacing.
- New Sidwalk in front of "Fish" section of the playground (prior to installation) -- 12" Thickened edge is recommended on the playground side to void washout under sidewalk.

Installation Charges on this proposal are based on NO UNFORESEEN conditions in the area, above or below the surface. If unforeseen conditions arise, the installation charges will change to reflect additional costs associated with dealing with those circumstances. Examples of this include but are not limited to:

site not ready upon installer's arrival, underground utilities, or difficulties with footers due to coral rock or ground water in the holes.

**Time Limitations Holding Prices Firm:**

Orders are shipped within our manufacturer's standard lead times. Requests for delayed shipping may result in additional costs due to increases in freight, material costs or other factors. To secure the prices on this proposal, the offer must be accepted prior to the expiration date noted.

If, during the performance of this contract, the price of a product increases 3% or more as documented by factory quotes, invoices or receipts to contractor (Rep Services, Inc.) from the date of the contract signing the price of shall be equitably adjusted by an amount reasonably necessary to cover such price increases. Where the delivery of a product is delayed, through no fault of contractor (RSI) as a result of the shortage or unavailability of a product, contractor (RSI) shall not be liable for any additional costs or damages associated with such delay(s).

The undersigned warrants that he/she is an authorized representative of the City of South Daytona noted and has the requisite authority to bind the City of South Daytona and/or principal.

Accepted By:  
City of South Daytona

Company Name

Authorized By

Printed Name

Date

As Its: (Title)

DRAWN BY:KCM		PG-1		
PLAY EQUIPMENT PLAN				
TOTAL AREA: 1870 SF				
FALL HEIGHT: 8'				
BORDER: 69 LF CURB				
USER CAPACITY: 40				
SURFACING: 1870 SF PIP				
SUBGRADE ELEV.: -7.75" BFF				
ADA SCHEDULE	FBC 240.2.1.2	TOTAL PLAY ACTIVITIES 2-5:		
		TOTAL PLAY ACTIVITIES 5-12: 3		
		ACCESSIBLE ELEVATED ACTIVITIES	ACCESSIBLE GROUND-LEVEL ACTIVITIES	ACCESSIBLE GROUND-LEVEL PLAY TYPES
2-5	REQ	N/A	N/A	N/A
	PROV	N/A	N/A	N/A
5-12	REQ	N/A	N/A	2
	PROV	N/A	2	2

**WELCOME SIGN**  
TO BE LOCATED IN CONSULTATION WITH OWNER

**⚠ WARNING**  
INSTALLATION OVER A HARD SURFACE SUCH AS CONCRETE, ASPHALT, OR PACKED EARTH MAY RESULT IN SERIOUS INJURY OR DEATH FROM FALLS.

**⚠ WARNING**  
SURFACING AND PLAYSURFACES MAY BECOME **HOT** AND CAUSE BURNS. CHECK FOR HOT SURFACES PRIOR TO PLAYING ON THE PLAYGROUND.

**GENERAL NOTES:**  
1. EQUIPMENT LOCATION TO BE FIELD VERIFIED PRIOR TO CONSTRUCTION  
2. ACCESSIBLE ROUTE OF TRAVEL TO THE PLAYGROUND TO BE PROVIDED BY OTHERS, UNLESS OTHERWISE NOTED  
3. BASE MUST EXHIBIT POSITIVE DRAINAGE IN ALL AREAS

**COASTAL NOTE**  
DUE TO THE PROJECT PROXIMITY TO THE WATER, LANDSCAPE STRUCTURES' COASTAL WARRANTY WILL BE APPLIED. CHECK WARRANTY DOCUMENT FOR MORE DETAILS.

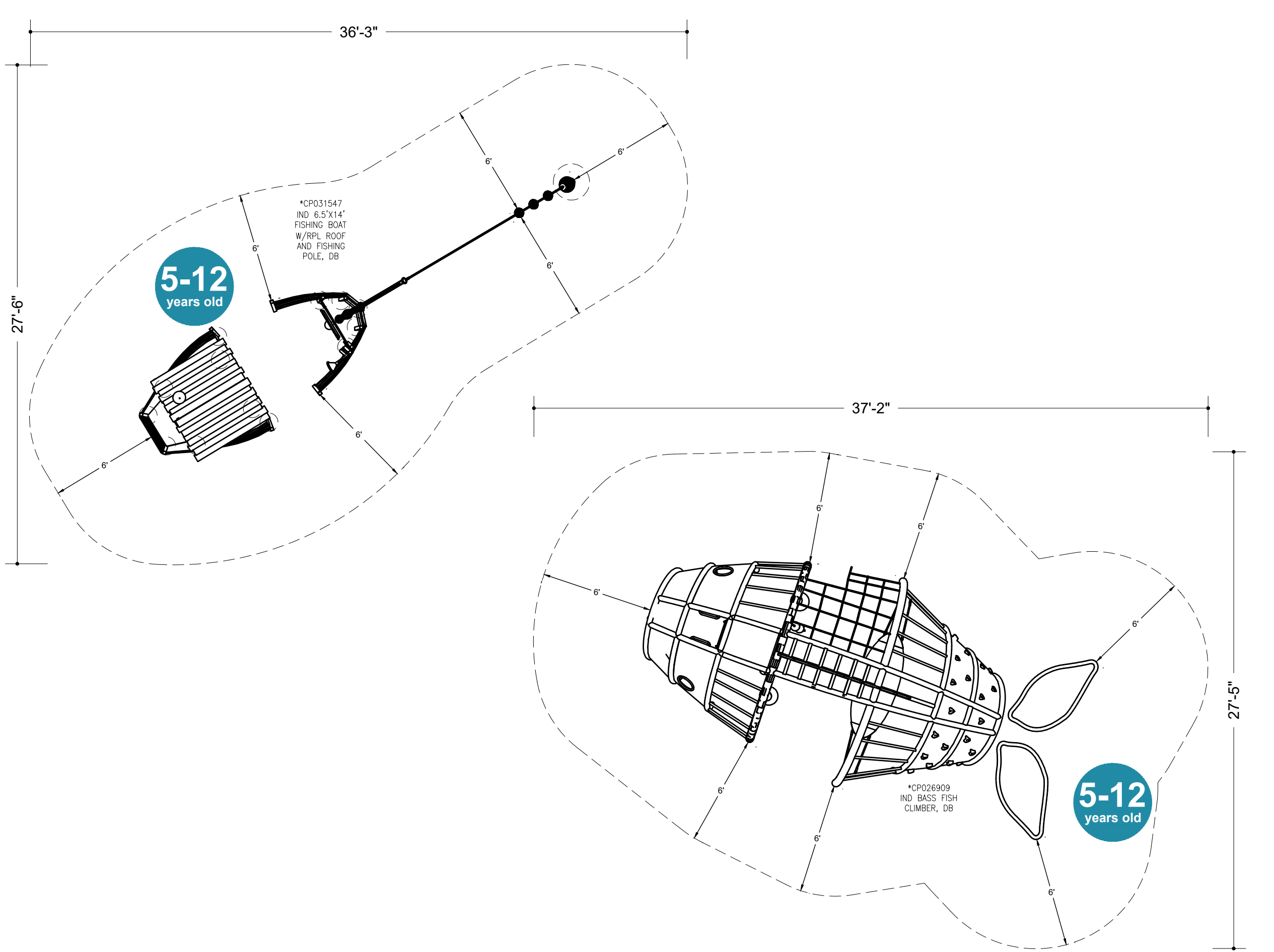

# Magnolia Park

South Daytona, FL  
PROJECT: 19712-1-3 2023.1  
NOT FOR CONSTRUCTION

DRAWN BY: KCM	<b>PG-2</b> INSTALL PLAN
<b>TOTAL AREA:</b> 1870 SF	
<b>FALL HEIGHT:</b> 8'	
<b>BORDER:</b> 69 LF CURB	
<b>USER CAPACITY:</b> 40	
<b>SURFACING:</b> 1870 SF PIP	
<b>SUBGRADE ELEV.:</b> -7.75" BFF	

**COASTAL NOTE**  
 DUE TO THE PROJECT PROXIMITY TO THE  
 WATER, LANDSCAPE STRUCTURES'  
 COASTAL WARRANTY WILL BE APPLIED.  
 CHECK WARRANTY DOCUMENT FOR MORE  
 DETAILS.

NOTE: SOME ITEM(S) ON THIS QUOTE WILL BE  
 PRE-ASSEMBLED AND MAY REQUIRE SPECIAL  
 EQUIPMENT TO INSTALL. A SPECIAL FREIGHT  
 QUOTE WILL BE REQUIRED

EXTENTS OF  
 OLD CURB

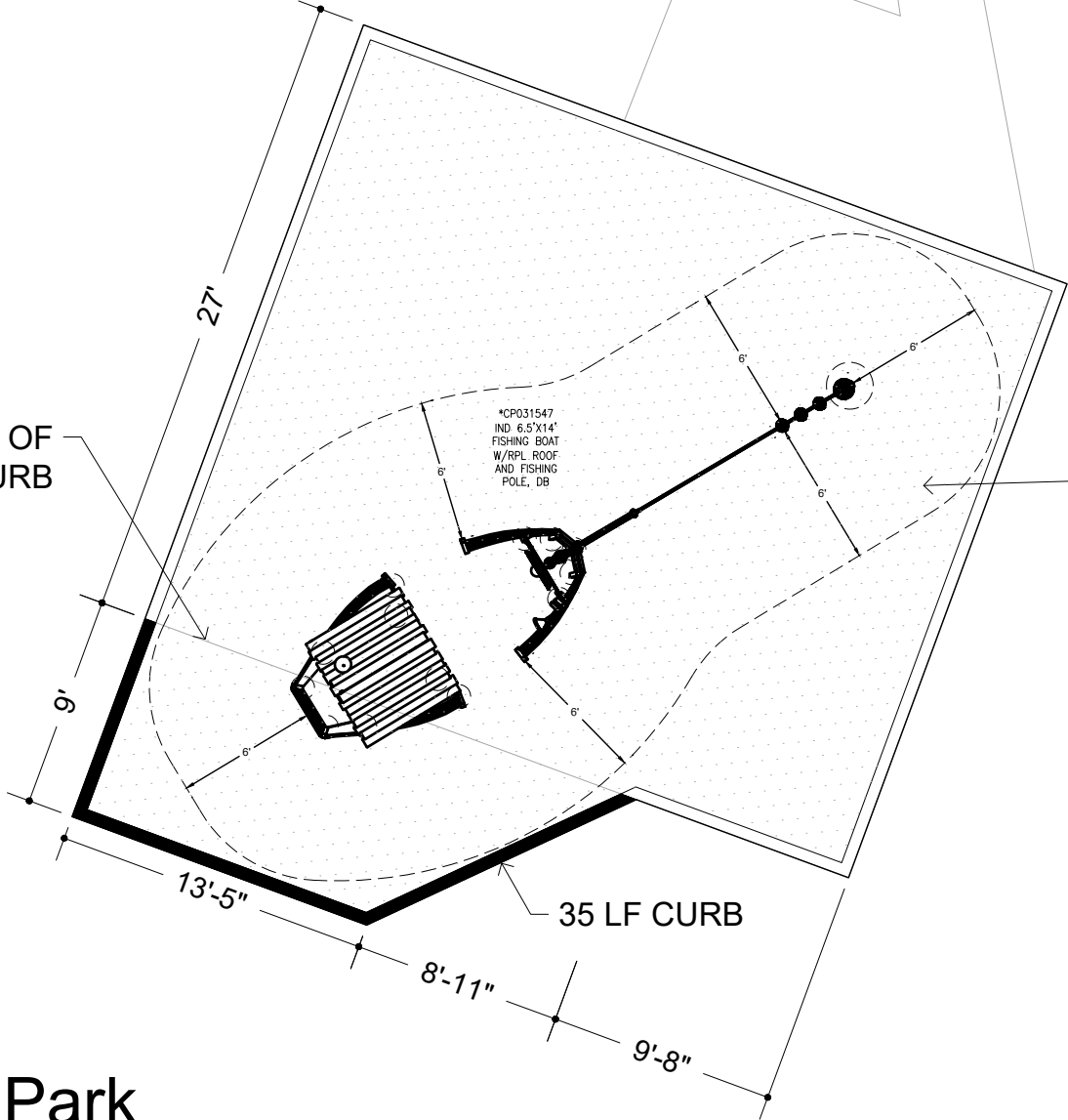

EXTENTS OF  
 OLD CURB  
 22 LF CURB

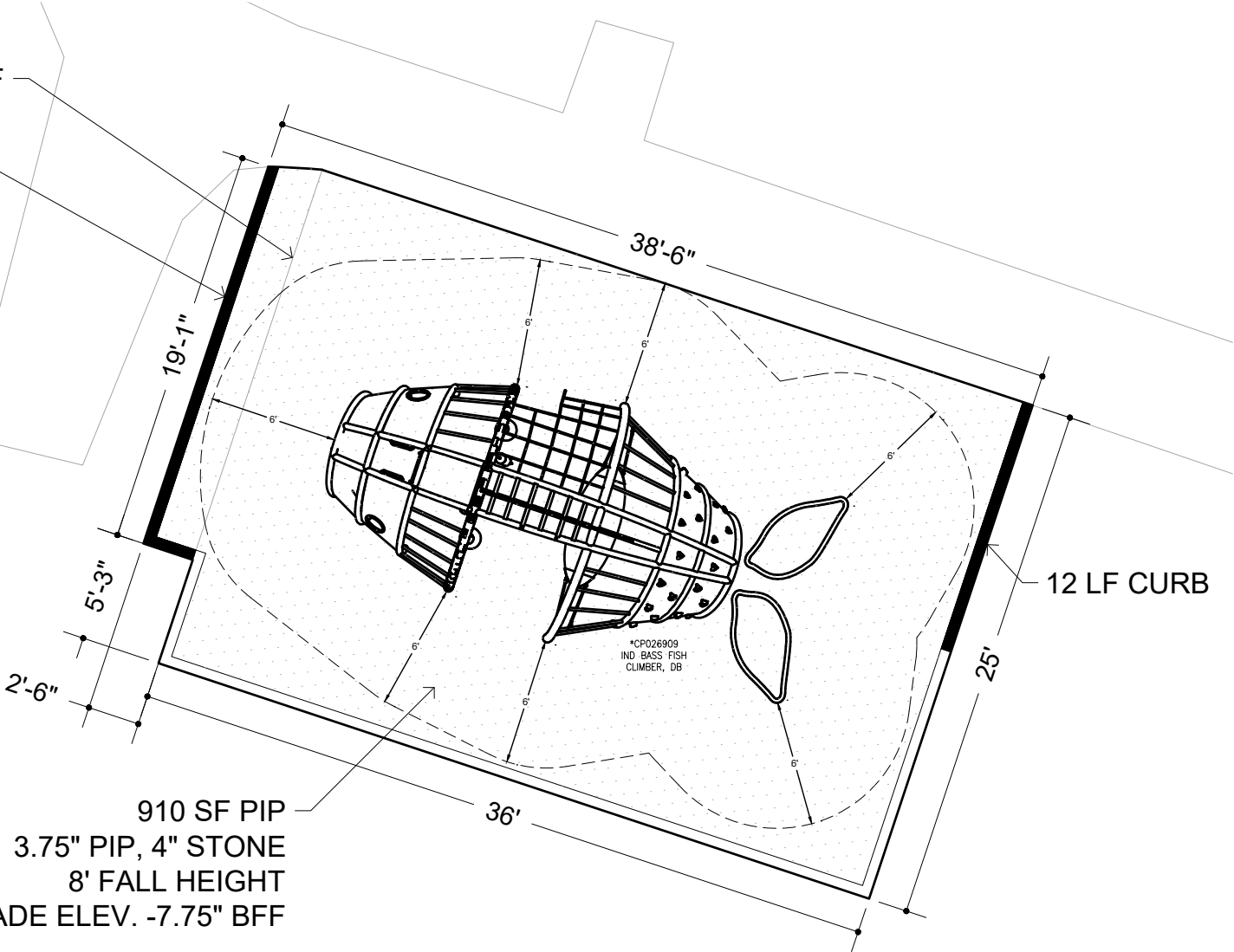

910 SF PIP  
 3.75" PIP, 4" STONE  
 8' FALL HEIGHT  
 SUBGRADE ELEV. -7.75" BFF

960 SF PIP  
 2" PIP, 4" STONE  
 4' FALL HEIGHT  
 SUBGRADE ELEV. -6" BFF

# Magnolia Park

South Daytona, FL  
 PROJECT: 19712-1-3 2023.1  
 NOT FOR CONSTRUCTION

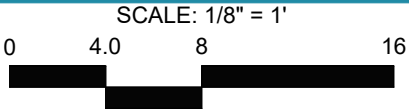

**REP SERVICES, INC.**  
 Experts at Play & Outdoor Spaces



4/3/2023 2:40:51 PM



<div>DRAWN BY: KCM</div>	<div>PG-3</div> <div>SURFACING PLAN</div>
TOTAL AREA: 1870 SF	
FALL HEIGHT: 8'	
BORDER: 69 LF CURB	
USER CAPACITY: 40	
SURFACING: 1870 SF PIP	
SUBGRADE ELEV.: -7.75" BFF	

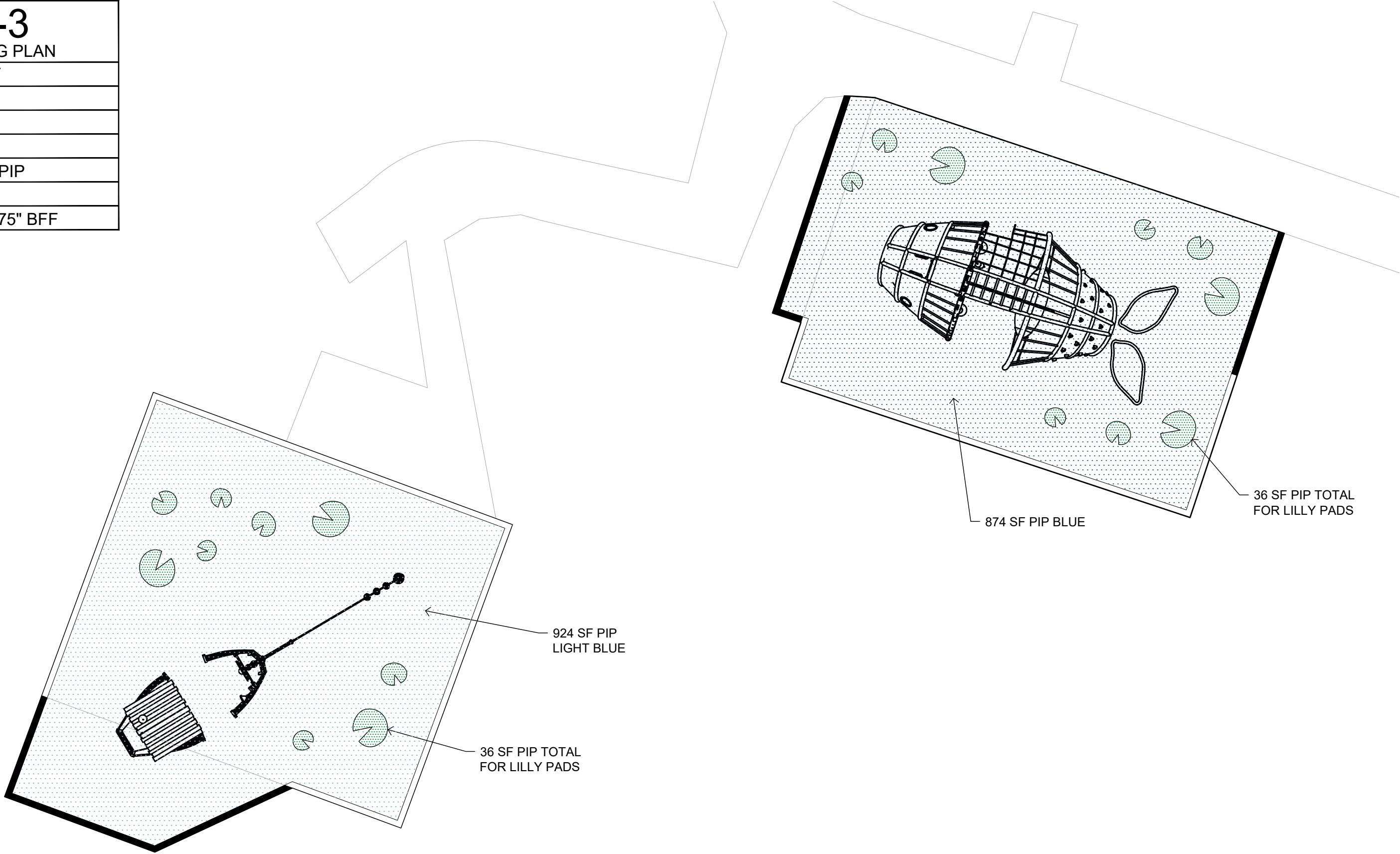

# Magnolia Park

South Daytona, FL  
PROJECT: 19712-1-3 2023.1  
NOT FOR CONSTRUCTION

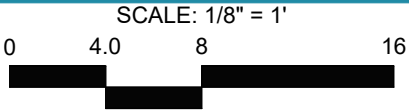

REP SERVICES, INC.  
Experts at Play & Outdoor Spaces



4/3/2023 2:40:52 PM

<div>DRAWN BY: KCM</div>	<div>PG-4</div> <div>DETAILS</div>
TOTAL AREA: 1870 SF	
FALL HEIGHT: 8'	
BORDER: 69 LF CURB	
USER CAPACITY: 40	
SURFACING: 1870 SF PIP	
SUBGRADE ELEV.: -7.75" BFF	

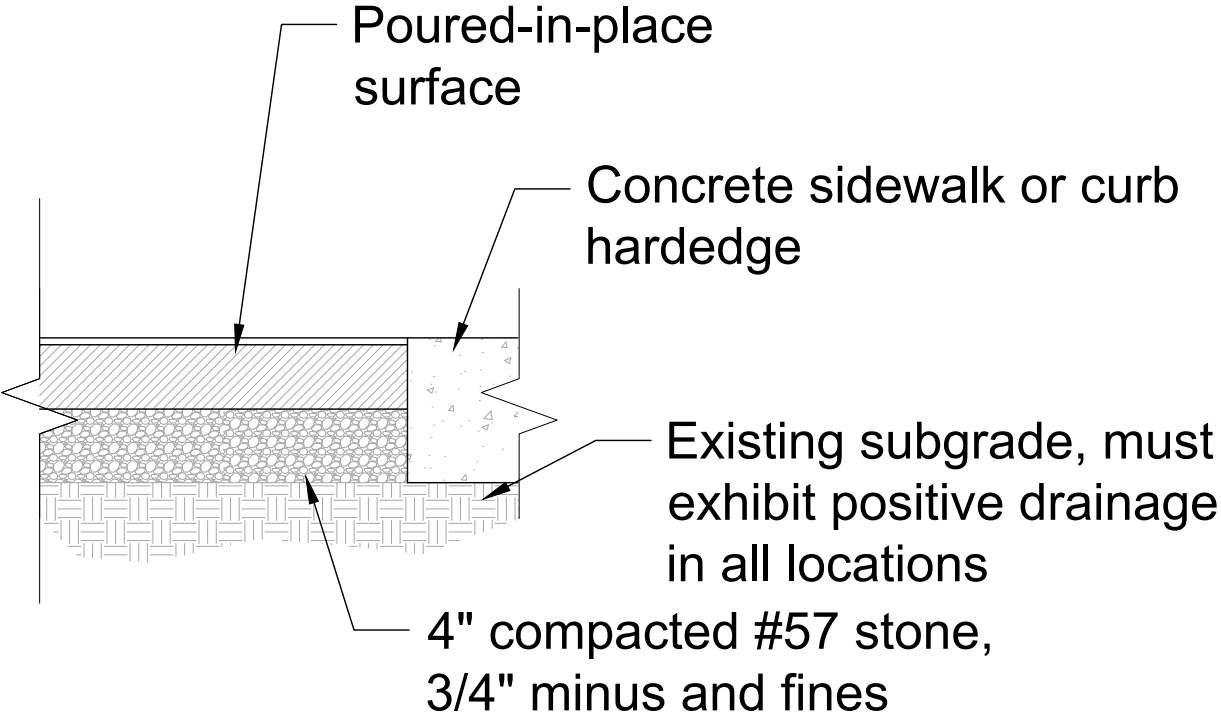

 Poured-in-Place Surfacing

Magnolia Park



# Magnolia Park Fishing Themed Playground













